

**COUNTY OF LOS ANGELES**

**ROAD DEPARTMENT**



**ARTESIA QUAD**

**BENCH MARKS**

**1960**

## PREFACE

The Road Department level net is composed of more than 1,000 miles of levels supporting in excess of 10,000 bench marks. In 1964-65, a major readjustment of the net was undertaken. To emphasize the complete break with previous elevations, the SY, SG & SL series bench marks have been re-labeled BY, BG & BL, respectively.

To facilitate the adjustment, indexing, and distribution of adjusted values of the net, the County territory was divided into 31 quads or areas. For identification purposes each quad was given a name, viz., "Rosemead," "La Mirada," "Santa Fe," etc. When bench marks and elevations in the Road Department net are used, the name of the quad in which the bench mark is located and the date of the adjustment of the elevation must be included in the bench mark description, e.g.,

BG 1887 --L+BN IN CONC HDWL OF DRAIN PIPE UNDER DR 218 FT  
NE +18 FT SE C/L INT SAN JOSE HILLS RD +CAMERON AVE MKD (BM)  
( COVINA --1965) ELEV. 696.238

It is expected that this general adjustment will, for the most part, remain sound for the next 8 to 12 years. As new circuits are completed, however, re-adjustment of individual quads may become advisable. It is expected that these subsequent adjustments will be in the nature of a few hundredths of a foot. When a quad is re-adjusted, new elevation lists will be published and the date of the re-adjustment will replace the "1965" at the end of the bench mark description. Two bench marks in the same quad with different adjustment dates will not normally join each other. Since all adjustments taper out to nothing at the periphery of the quad, any bench mark in one quad will join any bench mark in another quad regardless of their respective adjustment dates.

The basic accuracy of the net is reflected by an indicated field probable error of plus or minus 0.012 foot per mile of leveling as determined from 298 conditions of closure. However, many years experience in vertical control in the greater Los Angeles basin and Antelope Valley indicate that because of varying degrees of subsidence and heaving, the true datum is recovered only by obtaining substantial agreement of a number of bench marks.

The users of this net are invited to assist in its maintenance by notifying this Department of cases of obliteration, apparent mistakes in descriptions or elevations, and proven disturbance of bench marks.

---

DATUM: U. S. Coast and Geodetic Survey Sea Level Datum  
of 1929, through the medium of the Los Angeles  
County Engineer Precise Level Net, 1963 Adjust-  
ment.

ABBREVIATIONS USED IN BENCH MARK LISTINGS

ABUT - - - - -	Abutment	EC - - - - -	End of Curve
ALG - - - - -	Along	ENT - - - - -	Entrance
ANG PT - - - - -	Angle Point	FL - - - - -	Floor
B/W - - - - -	Back of Walk	FTG - - - - -	Footing
BCR - - - - -	Beginning of Curb Return	F/W - - - - -	Front of Walk
BC - - - - -	Beginning of Curve	GAR - - - - -	Garage
BLDG - - - - -	Building	HDWL - - - - -	Headwall
BM - - - - -	Bench Mark	HSE - - - - -	House
BT SPK - - - - -	Boat or Bolt Spike	INT - - - - -	Intersection
BR CAP - - - - -	Brass or Bronze Cap	IP - - - - -	Iron Pipe
C B - - - - -	Catch Basin	LT - - - - -	Left
CTR - - - - -	Center	LACE - - - - -	L. A. City Engineer
C/L - - - - -	Center Line	LACS - - - - -	L. A. County Engineer
C/L INT - - - - -	Center Line Intersection	LAFC - - - - -	L. A. Co. Flood Control
C/L PROD - - - - -	Center Line Produced	L+BN - - - - -	Lead and Bench Nail
CONC - - - - -	Concrete	L+BR - - - - -	Lead and Brad
COR - - - - -	Corner	L+N - - - - -	Lead and Nail
COE - - - - -	Corps of Engineers	L+RDEM TAG - - - - -	Lead and Road Dept. Bench Mark Tag
CULV - - - - -	Culvert	L+SPK - - - - -	Lead and Spike
CB - - - - -	Curb	L+T - - - - -	Lead and Tack
CS MON - - - - -	County Engineer Monument	MCR - - - - -	Middle of Curb Return
CS BR CAP - - - - -	County Engineer Brass Cap	MKD - - - - -	Marked
CT SPK - - - - -	Cut Spike	MC - - - - -	Middle of Curve
DR - - - - -	Drive or Driveway	MON - - - - -	Monument
E/O - - - - -	East of	N/O - - - - -	North of
ECR - - - - -	End of Curb Return	NR - - - - -	Near

ABBREVIATIONS USED IN BENCH MARK LISTINGS . . . CONTINUED

OPP - - - - - Opposite  
PI - - - - - Point of Intersection  
PK+W - - - - - PK Nail and Washer  
P/L - - - - - Property Line  
POST - - - - - Point on Semi-Tangent  
PP - - - - - Power Pole  
PVMT - - - - - Pavement  
PROD - - - - - Produced  
RD - - - - - Road  
RDBM - - - - - Road Dept. Bench Mark  
RR - - - - - Railroad  
RT - - - - - Right  
R/W - - - - - Right of Way  
SDMH - - - - - Storm Drain Manhole  
SMH - - - - - Sewer Manhole  
SPK - - - - - Spike  
ST+W - - - - - Spike Tin and Washer  
S/O - - - - - South of  
TP - - - - - Telephone Pole  
USC+GS - - - - - U. S. Coast and Geodetic Survey  
USGS - - - - - U. S. Geological Survey  
WK - - - - - Walk  
W/O - - - - - West of

FIRESTONE BLVD.

ROSECRANS AVE.

MAPLEDALE ST.

EXCELSIOR DR.

ALONDRA BLVD.

VALLEY VIEW AVE.

TO LA MIRADA QUAD

ARTESIA BLVD.

VALLEY VIEW AVE.

SOUTH ST.

DEL AMO BLVD.

CARMENITA AVE.

CARSON ST.

SCALE - 1 MILE

# ARTESIA QUAD

LOS ANGELES COUNTY ROAD DEPARTMENT  
SURVEY SECTION FIELD ENGINEERING DIVISION

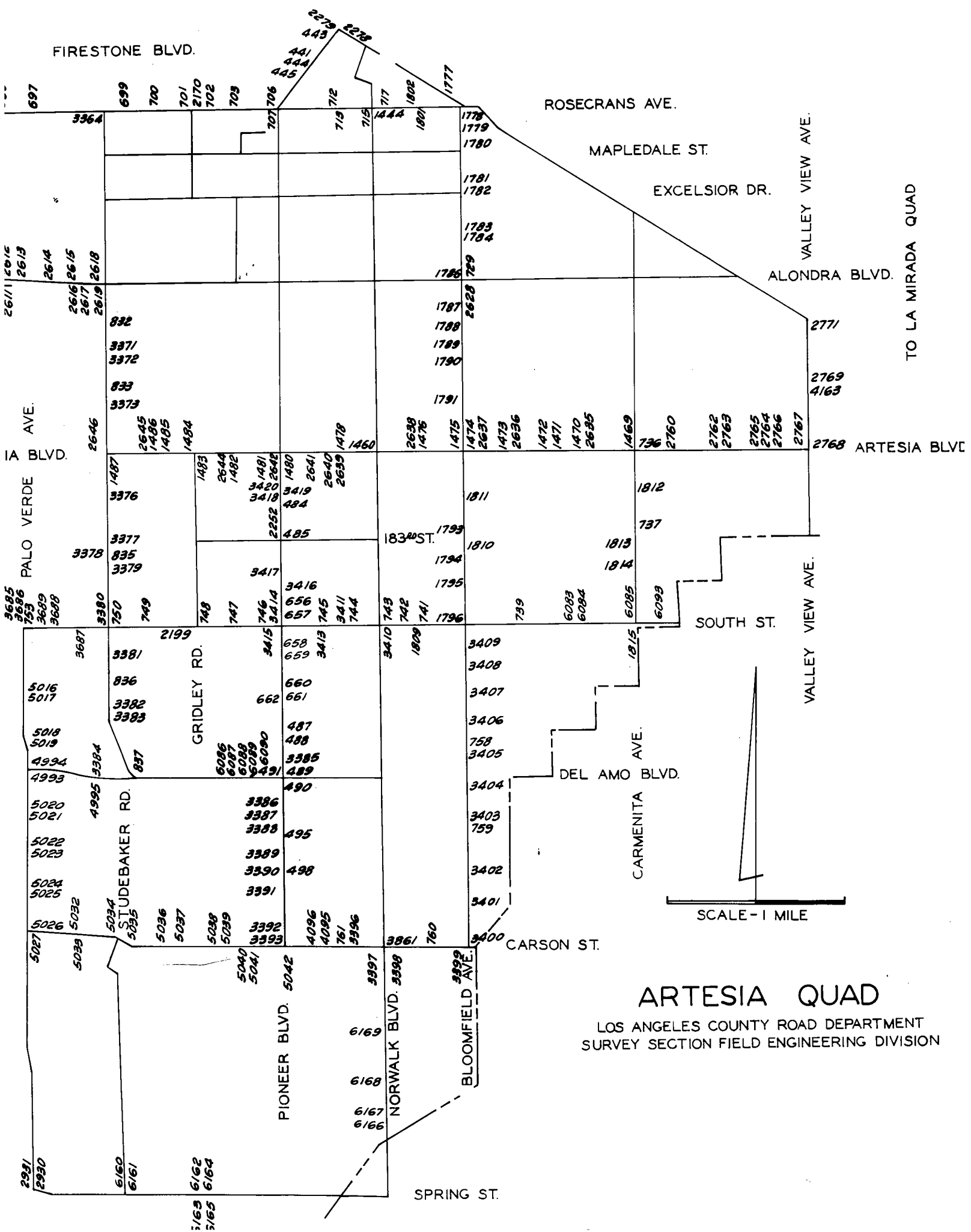

FIRESTONE BLVD.

ROSECRANS AVE.  
MAPLEDALE ST.  
EXCELSIOR DR.  
ALONDR BLVD.

ROSECRANS AVE.

MAPLEDALE

EXCE

TO BELFLOWER QUAD  
WOODRUFF AVE.

ARTESIA BLVD.

PALO VERDE AVE.

SOUTH ST.

DEL AMO BLVD.

TO LAKEWOOD QUAD  
CARSON ST.

SPRING ST.

3685  
3686  
753  
3689  
3688

5016  
5017  
5018  
5019  
4994  
4993

5020  
5021  
5022  
5023  
5024  
5025

5026  
5027  
5033  
5034  
5035  
5036  
5037

5040  
5041  
5042

3380  
750  
749  
748  
747  
746  
3414  
3417

3381  
836  
3382  
3383  
837  
3384  
3385  
3386  
3387  
3388  
3389  
3390  
3391

3392  
3393  
4096  
4095  
761  
3396

6169  
6168  
6167  
6166

1487  
3376  
3377  
835  
3379

2199  
3381  
836  
3382  
3383  
837  
3384  
3385  
3386  
3387  
3388  
3389  
3390  
3391

3392  
3393  
4096  
4095  
761  
3396

6169  
6168  
6167  
6166

1483  
2644  
1482  
3420  
3418  
2252  
2648  
1480  
3419  
2641  
2640  
2639  
1478  
1460

6086  
6087  
6088  
6089  
6090  
6091  
3386  
3387  
3388  
495  
3389  
3390  
3391

3392  
3393  
4096  
4095  
761  
3396

6169  
6168  
6167  
6166

3416  
656  
657  
3413  
3410  
743  
742  
741  
1796

658  
659  
3413  
3410  
743  
742  
741  
1796

3397  
6169  
6168  
6167  
6166

6169  
6168  
6167  
6166

1834  
1799  
1810  
1794  
1795  
1796

3409  
3408  
3407  
3406  
758  
3405  
3404  
3403  
759  
3402  
3401  
3400

3397  
6169  
6168  
6167  
6166

6169  
6168  
6167  
6166

1811  
1810  
1813  
1814

3409  
3408  
3407  
3406  
758  
3405  
3404  
3403  
759  
3402  
3401  
3400

3397  
6169  
6168  
6167  
6166

6169  
6168  
6167  
6166

1811  
1810  
1813  
1814

3409  
3408  
3407  
3406  
758  
3405  
3404  
3403  
759  
3402  
3401  
3400

3397  
6169  
6168  
6167  
6166

6169  
6168  
6167  
6166

1811  
1810  
1813  
1814

3409  
3408  
3407  
3406  
758  
3405  
3404  
3403  
759  
3402  
3401  
3400

3397  
6169  
6168  
6167  
6166

6169  
6168  
6167  
6166

1811  
1810  
1813  
1814

3409  
3408  
3407  
3406  
758  
3405  
3404  
3403  
759  
3402  
3401  
3400

3397  
6169  
6168  
6167  
6166

6169  
6168  
6167  
6166

AR  
LOS ANGELES  
SURVEY SECT

QUAD-YEAR	ELEV	DESCRIPTION (INCLUDE QUAD AND YEAR IN DESCRIPTION)	BM NUMBER
BASELINE (1955)	94.838	L+T 1FT± N CB RET @ NE COR PINE ST + SAN ANTONIO DR	SY 441
BASELINE (1955)	96.495	L+T 5FT± N CB RET @ NW COR SAN ANTONIO DR + FRONT ST	SY 443A
BASELINE (1955)	93.518	L+T 2FT± E END CF CB @ SE COR WALNUT ST + SAN ANTONIO DR	SY 444A
BASELINE (1955)	93.225	L+T 2FT± E CB RET @ NE COR SYCAMORE ST + SAN ANTONIO DR	SY 445A
ARTESIA (1960)	54.204	BT SPK 5FT± E CB RET @ SE COR PIONEER BLVD + ASHWORTH ST	SY 484
ARTESIA (1960)	51.662	RDBM TAG W CB 1FT± N BCR @ SW COR PIONEER BLVD + 183RD ST 58FT± N + 30FT± W C/L INT	SY 485A
ARTESIA (1960)	45.624	SET L+BRAD CONC PLATFORM OF DAIRY 87FT± W C/L PIONEER BLVD + 597FT± S C/L 195TH ST MKD (BM)	SY 487A
ARTESIA (1960)	44.421	RD HD SPK S CB OF S DR TO DAIRY 645FT± S C/L 195TH ST + 33FT± W C/L PIONEER BLVD	SY 488A
ARTESIA (1960)	40.408	SQ HD SPK W CB 100FT± S BCR @ SW COR PIONEER BLVD + LOS COYOTES BLVD 220FT± S + 40FT± W C/L INT CB MKD (SD 1809)	SY 489A
ARTESIA (1960)	36.499	L+T E CB C/L PROD WALCROFT ST + PIONEER BLVD	SY 495
ARTESIA (1960)	48.237	L+N 3.5FT± N CB RET @ NW COR PIONEER BLVD + 188TH ST	SY 656
ARTESIA (1960)	47.739	L+T NR EDGE OF PVMT 2.5FT± S OF C/L OF SOUTH ST 27.0FT± E OF C/L OF PIONEER BLVD	SY 657
ARTESIA (1960)	46.582	L+T CONC PORCH CF BLDG NO 19210 PIONEER BLVD 75FT± E C/L + 882FT± S C/L SOUTH ST MKD (BM)	SY 658A
ARTESIA (1960)	44.879	CONC MON 18IN DP 30FT± W C/L PIONEER BLVD 897FT± S SOUTH ST	SY 659
ARTESIA (1960)	43.801	L+N CONC DRWY 152FT± S C/L LINCCLN AVE + 42FT± E C/L PIONEER BLVD	SY 660
ARTESIA (1960)	43.640	CUT SPK CONC MON 30FT± N + 30FT± E C/L INT PIONEER BLVD + LINCCLN AVE	SY 661A
ARTESIA (1960)	43.079	CUT SPK CONC MON 30FT± S + 30FT± E C/L INT PIONEER BLVD + LINCCLN AVE	SY 662A
BASELINE (1955)	87.876	FC BRONZE DISC @ SW COR DAIRY PLATFORM 75FT± N C/L ROSECRANS AVE 30FT± E SAN GABRIEL RIV BRIDG	SY 697A
BASELINE (1955)	84.708	L+N 1FT± E BCR @ SE COR ROSECRANS AVE + CROSSDALE AVE	SY 699A
BASELINE (1955)	85.015	L+N 1FT± E BCR @ SE COR ROSECRANS AVE + ELMCROFT AVE	SY 700A
BASELINE (1955)	84.518	L+T N CB ROSECRANS AVE 36FT± N C/L + 37FT± W C/L PROD GRIDLEY RD	SY 701B
BASELINE (1955)	85.404	L+N 1FT± E BCR @ SE COR ROSECRANS AVE + GARD AVE	SY 702A
BASELINE (1955)	86.960	L+N 1FT± S BCR @ SE COR ROSECRANS AVE + JERSEY AVE	SY 703A

QUAD-YEAR	ELEV	DESCRIPTION (INCLUDE QUAD AND YEAR IN DESCRIPTION)	BM NUMBER
BASELINE (1955)	86.716	CS MON IN WELL 13IN DN CN NW COR ROSECRANS AVE + PIONEER BLVD 86FT± N + 40FT± W C/L INT MKD (WHITTIER C 124 1959)	SY 706A
BASELINE (1955)	87.258	RDBM MON FLUSH IN CONC SQ POST ON SW COR ROSECRANS AVE + ARLEE AVE 835FT± + 20FT± W C/L INT MKD (BM 184)	SY 707A
ARTESIA (1960)	89.469	RDBM TAG S CB 3FT± W BCR @ SW COR ROSECRANS AVE + FUNSTON AVE 40FT± S + 40FT± W C/L INT	SY 712A
ARTESIA (1960)	89.487	RDBM TAG S CB 3FT± E BCR @ SE COR ROSECRANS AVE + FUNSTON AVE 40FT± S + 40FT± E C/L INT	SY 713A
ARTESIA (1960)	90.479	CS MON IN WELL 9IN DN ON SE COR ROSECRANS AVE + NORWALK BLVD 59FT± S + 22FT± E C/L INT 1.5 BACK OF CB MKD (BM 41-9 1954)	SY 715A
ARTESIA (1960)	90.000	L+N 1FT± W CB RET @ SW COR ROSECRANS AVE + DISNEY AVE	SY 717
ARTESIA (1960)	70.179	CS MON @ INT BLOOMFIELD AVE + ALONDRA BLVD	SY 729
ARTESIA (1960)	58.787	L+T @ C/L INT CARMENITA RD + ARTESIA AVE	SY 736
ARTESIA (1960)	52.312	L+N 42FT± W C/L CARMENITA RD @ N EDGE CONC DRWY HSE NO 18029 450FT± N C/L 14TH ST	SY 737
ARTESIA (1960)	45.789	L+N SE COR DAIRY PLATFORM 70FT± N C/L SOUTH ST @ HSE NO 12815 1/2MI± E BLOOMFIELD AVE	SY 739
ARTESIA (1960)	48.204	L+N NW COR DAIRY PLATFORM 70FT± S C/L OF SOUTH ST 1/2MI± W OF BLOOMFIELD AVE NR HSE NO 12426	SY 741
ARTESIA (1960)	44.619	L+T PVMT NR C/L ELY AVE 1FT± S C/L SOUTH ST	SY 742
ARTESIA (1960)	44.378	CHIS SQ 60FT± S C/L SOUTH ST @ SE COR NORWALK BLVD 4FT± S END CB	SY 743
ARTESIA (1960)	45.918	RDBM TAG S CB 1FT± W BCR @ SW COR SOUTH ST + GRAYLAND AVE 40FT± S + 56FT± W C/L INT	SY 744A
ARTESIA (1960)	48.937	S+W ON C/L OF SOUTH ST 2FT± SW OF S RAIL PERR 900FT± E PIONEER BLVD	SY 745
ARTESIA (1960)	45.849	S+W @ C/L INT ADAMS ST AKA ALBURTIS ST + SOUTH ST	SY 746
ARTESIA (1960)	46.992	RDBM TAG S CB SOUTH ST 40FT± S C/L + 30FT± W C/L JERSEY AVE PROD	SY 747A
ARTESIA (1960)	51.034	L+T NR C/L GRIDLEY RD 1FT± S C/L SOUTH ST	SY 748
ARTESIA (1960)	50.472	CUT SPK CONC PVMT 14FT± S C/L SOUTH ST FRONT OF HSE NO 1116C	SY 749
BASELINE (1955)	49.807	SW ONE OF 4 L+T STRADDLERS NR C/L INT STUDEBAKER RD + SOUTH ST	SY 750A
BASELINE (1955)	51.528	CT SPK CONC PVMT 14FT± S C/L SOUTH ST 85FT± W C/L PALO VERDE AVE	SY 753
ARTESIA (1960)	41.247	L+N 26FT± W C/L BLOOMFIELD AVE + 180FT± S C/L SANTA ANA BRANCH PERR @ NE COR DRWY 700FT± N C/L DEL AMO BLVD	SY 758A



QUAD-YEAR	ELEV	DESCRIPTION (INCLUDE QUAD AND YEAR IN DESCRIPTION)	BM NUMBER
ARTESIA (1960)	37.755	LA CO RD DEPT BM TAG E CB 40FT± E C/L BLOOMFIELD AVE 285FT± N OF LEMMING ST	SY 759A
ARTESIA (1960)	30.524	L+T S CB CARSON ST 40FT S C/L + 34FT E C/L CLARETTA PROD 4FT± W OF CB	SY 760A
ARTESIA (1960)	29.814	RAM SET + WASHER 3FT± N OF CB IN CB @ NW COR OF CARSON ST + JUAN AVE 42FT± N + 55FT± W C/L INT	SY 761A
BASELINE (1955)	71.816	L+N NW COR DAIRY PLATFORM 77FT± E C/L STUDEBAKER RD @ HSE NO 16528	SY 832
BASELINE (1955)	55.184	L+N CB E SIDE STUDEBAKER RD NR N SIDE 4FT WK IN FRONT OF HSE NO 18406	SY 835A
ARTESIA (1960)	47.545	L+N NW COR PIER @ NW COR EDISON TOWER 100FT± E STUDEBAKER RD 3000FT± S SOUTH ST	SY 836
ARTESIA (1960)	44.107	L+N NE COR DAIRY PLATFORM 23FT± S C/L DEL AMO ST @ HSE NO 11144	SY 837
BASELINE (1955)	73.861	L+T S CB ALONDRA BLVD 68FT± W C/L WOODRUFF AVE	SY 960A
BASELINE (1955)	78.775	L+T NR S EDGE N STRIP CONC DRWY 50FT± E C/L WOODRUFF AVE @ HSE NO 15304	SY 962
ARTESIA (1960)	91.235	L+N 1 FT± S CB RET @ SE COR NORWALK BLVD + ROSECRANS AVE	SY 1444
ARTESIA (1960)	57.398	CS MON IN WELL SIN DN ON NW COR ARTESIA BLVD + NORWALK BLVD 141FT± N + 11FT± W C/L INT MKD (BM 41-5 1954)	SY 1460A
ARTESIA (1960)	58.174	L+T C/L INT ARTESIA BLVD + NORWALK BLVD	SY 1461
ARTESIA (1960)	57.659	CS MON IN WELL 16IN DN 12FT± S + 8 FT± W C/L INT ARTESIA BLVD + CARMENITA RD	SY 1469
ARTESIA (1960)	60.086	L+T NE COR LOADING PLATFORM DAIRY BLDG 77FT± S C/L ARTESIA BLVD 100FT± E HSE NO 13150	SY 1470
ARTESIA (1960)	56.410	L+BN S CONC HDWL CONC BOX CULV 20FT± E C/L INT SHOEMAKER AVE + ARTESIA BLVD	SY 1471
ARTESIA (1960)	55.503	L+BN C/L CONC BOX CULV 6IN FROM N HDWL 20FT± E C/L SHOEMAKER AVE + ARTESIA BLVD	SY 1472
ARTESIA (1960)	57.272	L+BN E END CONC CB 80FT± N C/L ARTESIA BLVD @ DAIRY BARN HSE NO 12739	SY 1473A
ARTESIA (1960)	57.008	L+SPK CONC PVMT 60FT± E + 10FT± N C/L INT BLOOMFIELD AVE + ARTESIA BLVD	SY 1474
ARTESIA (1960)	57.058	L+BN NR S EDGE CONC PVMT OF ARTESIA BLVD ON SW COR BLOOMFIELD AVE 95FT± S + 75FT± W C/L INT	SY 1475A
ARTESIA (1960)	59.207	L+BN NW COR LOADING DOCK MILK HSE 100FT± E HSE NO 12444 ARTESIA BLVD	SY 1476
ARTESIA (1960)	54.022	RDBM TAG S CB ARTESIA BLVD SERVICE RD ON SE COR GRAYLAND AVE 99FT± S + 42FT± E C/L INT	SY 1478A
ARTESIA (1960)	57.335	L+SPK IN CONC APRON ON SE COR ARTESIA BLVD + PIONEER BLVD 54FT± S + 62FT± E C/L INT	SY 1480A
ARTESIA (1960)	57.058	L+SPK CTR S CONC HDWL 15FT± S C/L ARTESIA BLVD 100FT± W HSE NO 11704	SY 1481

QUAD-YEAR	ELEV	DESCRIPTION (INCLUDE QUAD AND YEAR IN DESCRIPTION)	BM NUMBER
ARTESIA (1960)	58.107	L+T C/L WK @ W EDGE BLDG NO 11601 N SIDE ARTESIA BLVD 30FT± E C/L ROSETON AVE 52FT±N C/L ARTESIA BLVD	SY 1482
ARTESIA (1960)	61.497	RD HD L+SPK CONC HDWL ON NE COR ARTESIA BLVD + GRIDLEY RD 35FT± N + 24FT±E C/L INT MKD (MV 57)	SY 1483A
ARTESIA (1960)	60.815	L+BN 1FT FROM END CONC CB 55FT± W + 30FT± S C/L INT GRIDLEY RD + ARTESIA BLVD	SY 1484
ARTESIA (1960)	67.993	L+T SW COR CONC LOADING DOCK DAIRY 100FT±W HSE NO 11221 ARTESIA BLVD	SY 1485
ARTESIA (1960)	63.915	L+T E EDGE CONC DRWY 40FT± S C/L ARTESIA BLVD 20FT± E HSE NO 11110	SY 1486
BASELINE (1955)	83.781	RDBM TAG S CB 3.5FT± W BCR @ SW COR ROSECRANS AVE + BLOOMFIELD AVE 61FT± W + 40FT± S C/LINT	SY 1777A
BASELINE (1955)	83.817	RD MON E END S HDWL 24FT± E C/L BLOOMFIELD AVE 338FT± S C/L ROSECRANS AVE MKD (RD DEPT NO171)	SY 1778A
BASELINE (1955)	83.105	L+T CTR CONC HDWL 8FT± N OF N RAIL SPRR + 23FT± E C/L BLOOMFIELD AVE	SY 1779A
ARTESIA (1960)	78.777	L+T CTR CB RET SW COR MAPLEDALE ST + BLOOMFIELD AVE	SY 1780
ARTESIA (1960)	77.520	L+BRAD E CB 3FT± S BCR @ SE COR BLOOMFIELD AVE + EXCELSIOR DR 68FT± S + 40FT± E C/L INT	SY 1781A
ARTESIA (1960)	77.502	L+T CTR CB RET NW COR EXCELSIOR DR + BLOOMFIELD AVE	SY 1782
ARTESIA (1960)	74.935	RDBM TAG W CB BLOOMFIELD AVE 40FT± W C/L + 7FT± N C/L PROD MOLETTE ST	SY 1783A
ARTESIA (1960)	74.730	L+BRAD E CB 0.5FT± S BCR @ SE COR BLOOMFIELD AVE + MCLETTE ST 55FT± S + 40FT±E C/L INT	SY 1784A
ARTESIA (1960)	71.243	L+T N CB CONC DRWY 30FT± E C/L BLOOMFIELD AVE @ SE COR ALONDRA BLVD + BLOOMFIELD AVE	SY 1786
ARTESIA (1960)	68.157	L+T N SIDE CONC DRWY HSE NO 16104 E SIDE BLOOMFIELD AVE 35FT± OUT	SY 1787
ARTESIA (1960)	68.841	L+BN NE COR CONC LOADING PLATFORM FRONT JOHN C BARBARIA + SONS DAIRY E SIDE BLOOMFIELD AVE 100FT± S HSE NO 16206	SY 1788
ARTESIA (1960)	66.355	L+BN S EDGE CONC APRON TO HSE NO 16420 30FT± E C/L BLOOMFIELD AVE	SY 1789
ARTESIA (1960)	64.977	L+T NW COR CONC LOADING PLATFORM DAIRY BARN 150FT± S 166TH ST 80FT±E C/L BLOOMFIELD AVE	SY 1790
ARTESIA (1960)	61.227	L+BN SE COR CONC ENT TO DAIRY HSE NO 17005 70FT± W C/L BLOOMFIELD AVE	SY 1791
ARTESIA (1960)	50.331	CS MON IN WELL 10IN DN @ OR NR C/L INT BLOOMFIELD AVE + 183RD ST MKD (1/4 COR R11WT35)	SY 1793A
ARTESIA (1960)	51.552	L+BN NE COR CONC ENT TO MILK HSE W SIDE BLOOMFIELD AVE 200FT± N HSE NO 18525	SY 1794
ARTESIA (1960)	48.737	L+T S EDGE CONC WK TO HSE NO 18724 35FT± E C/L BLOOMFIELD AVE	SY 1795

QUAD-YEAR	ELEV	DESCRIPTION (INCLUDE QUAD AND YEAR IN DESCRIPTION)	BM NUMBER
ARTESIA (1960)	46.736	L+BN SE COR CONC WK SE COR DAIRY BARN NW COR BLOOMFIELD AVE + SOUTH ST	SY 1796
ARTESIA (1960)	87.704	L+BN 2FT± W OF END OF S CB ROSECRANS AVE 205FT± E C/L SEAFORTH AVE SWLY SPRR	SY 1800
ARTESIA (1960)	87.992	L+BN 1FT± E CB RET IN N CB OF S SERVICE RD @ SE COR ROSECRANS BLVD + CAMEO AVE	SY 1801
ARTESIA (1960)	89.430	L+BN 1FT± W CB RET SW COR MADRIS AVE + ROSECRANS BLVD	SY 1802
ARTESIA (1960)	48.619	L+T E END OF CONC LOADING PLATFORM OF MILK BLDG 175FT±E ELY ST N SIDE SCUTH ST W HSE NO 12361	SY 1809
ARTESIA (1960)	50.489	L+T W EDGE CONC DRWY HSE 70FT± E C/L BLOOMFIELD AVE + 30FT± S C/L 183RD ST @ SE COR	SY 1810
ARTESIA (1960)	54.125	L+T N EDGE CONC DRWY HSE NO 17703 32FT± W C/L BLOOMFIELD AVE	SY 1811
ARTESIA (1960)	55.720	L+BN NE COR CONC DARY FEEDING PLATFORM 30FT± W C/L CARMENITA AVE 100FT± N HSE NO 17613	SY 1812
ARTESIA (1960)	49.482	CS MON IN CASING W/COVER 8FT± W C/L CARMENITA RD + 10FT± S C/L 183RD ST	SY 1813
ARTESIA (1960)	47.179	L+T N EDGE OF 1ST CONC STEP HSE NO 18605 60FT± W C/L CARMENITA RD	SY 1814
ARTESIA (1960)	41.895	CAST IRON MON IN CASING W/COVER C/L INT CARMENITA RD + SOUTH ST	SY 1815
BASELINE (1955)	90.290	RDBM TAG S CB ROSECRANS AVE 40FT± S C/L @ ANG PT OF CB TO BRIDGE OVER SAN GABRIEL RIV 500FT± W BRIDGE	SY 1989A
BASELINE (1955)	84.818	L+T W CB SYLVANWOOD AVE 1FT± N BCR @ NW COR ROSECRANS AVE	SY 2170A
ARTESIA (1960)	52.950	L+T @ SE COR OF CONC LOADING PLATFORM TO DAIRY BARN 32FT± W C/L GRIDLEY RD 165FT± N C/L ORANGETHORPE BLVD	SY 2199
ARTESIA (1960)	52.180	L+T E CB 13FT± N BCR @ NE COR PIONEER BLVD + 183RD ST 52FT± N + 30FT± E C/L INT	SY 2252A
BASELINE (1955)	96.379	L+SPK @ CTR CB RET NW COR FIRESTONE BLVD + SAN ANTONIO DR	SY 2278A
BASELINE (1955)	96.884	L+T E CB SAN ANTONIO DR 1FT± S CB RET @ SE COR FIRESTONE BLVD + SAN ANTONIO DR	SY 2279A
BASELINE (1955)	99.073	L+BN N CB ROSECRANS AVE NE COR BRIDGE OVER SAN GABRIEL RIV 1FT± W OF E END OF BRIDGE 23FT±N C/L ROSECRANS AVE	SY 2495A
BASELINE (1955)	101.448	L+BN N CB ROSECRANS AVE @ NW COR BRIDGE OVER SAN GABRIEL RIV 1FT± E OF W END OF BRIDGE 23FT± N C/L ROSECRANS AVE	SY 2496A
BASELINE (1955)	85.200	L+T N CB ROSECRANS AVE 1FT± W END CB ON APPROX E P/L HSE NO 10325	SY 2498
BASELINE (1955)	83.273	L+T N CB @ CB RET @ NW COR ROSECRANS AVE + CARPINTERO AVE	SY 2499A
BASELINE (1955)	84.622	RD MON IN WELL 81N DN @ OR NR C/L INT WOODRUFF AVE + ROSECRANS AVE MKD (LA CO RD DEPT 1953)	SY 2500A

QUAD-YEAR	ELEV	DESCRIPTION (INCLUDE QUAD AND YEAR IN DESCRIPTION)	BM NUMBER
BASELINE (1955)	84.081	CS MON IN WELL 9IN DN 15FT# S + 12FT# E C/L INT WOODRUFF + ROSECRANS AVE	SY 2501A
BASELINE (1955)	92.444	CO FLOOD CONTROL BR DISC IN SW COR BRIDGE NO B977 OVER SAN GABRIEL RIV 25FT# C/L ALONDRA BLVD MKD (BM 75-46)	SY 2611A
BASELINE (1955)	89.640	CORP OF ENGINEERS BR DISC IN SE COR BRIDGE NO B977 OVER SAN GABRIEL RIV 25FT S C/L ALONDRA BLVD MKD (SG 18 1958)	SY 2612A
BASELINE (1955)	73.422	L+T N CB 1FT# E CB RET @ NE COR ALONDRA BLVD SERVICE RD + DUMONT AVE	SY 2616A
BASELINE (1955)	73.948	L+T N CB 1FT# E OF CB RET @ NE COR ALONDRA BLVD SERVICE RD + LEIBACHER AVE	SY 2617A
BASELINE (1955)	72.813	CS REF MON IN WELL 9IN DN ON NW COR STUDEBAKER RD + ALONDRA BLVD 56FT# N + 62FT# W C/L INT MKD (ARTESIA A-2 NO 3 1960)	SY 2618A
BASELINE (1955)	73.258	CS REF MON IN WELL 9IN DN ON NE COR STUDEBAKER RD + ALONDRA BLVD 85FT# N + 50FT# E C/L INT MKD (ARTESIA A-2 NO 4 1960)	SY 2619A
ARTESIA (1960)	70.837	L+T CTR CONC DRWY HSE NO 12608 ALONDRA AVE 30FT# S C/L ALONDRA AVE 135FT# E C/L BLOOMFIELD AVE	SY 2628
ARTESIA (1960)	61.363	L+T SE COR CONC WK AROUND HSE NO 13239 ARTESIA BLVD 115FT# N C/L ARTESIA BLVD 1000FT# W CARMENITA RD	SY 2635
ARTESIA (1960)	56.171	L+T E CB OF E DRWY TO DAIRY BLDG 80FT# N C/L ARTESIA BLVD NR BCR CB RET 95FT# E HSE NO 12811	SY 2636A
ARTESIA (1960)	56.905	L+T W EDGE CONC DRWY 35FT# N C/L ARTESIA BLVD @ HSE NO 12655	SY 2637A
ARTESIA (1960)	59.172	L+T SW COR LOADING PLATFORM OF DAIRY 75FT#N C/L ARTESIA BLVD @ HSE NO 12345	SY 2638
ARTESIA (1960)	57.371	L+T W CB DRWY HSE NO 12121 ARTESIA BLVD 50FT#N C/L 5FT# N END CB	SY 2639
ARTESIA (1960)	54.340	RD HD L+SPK E CB 48FT# S BCR @ SE COR ARTESIA BLVD + ELAINE AVE 165FT# S + 18FT# E C/L INT	SY 2640A
ARTESIA (1960)	57.731	L+T W END GAS ISLAND 65FT# S C/L ARTESIA BLVD @ NO 11854	SY 2641
ARTESIA (1960)	57.967	L+BRAD WK AROUND BLDG ON NE COR ARTESIA BLVD + PIONEER BLVD 52FT# N + 48FT# E C/L INT	SY 2642A
ARTESIA (1960)	59.435	L+T NE COR CONC DRWY TO MIERMAS DAIRY NO 11446 ARTESIA BLVD 60FT# S C/L + C.1MI# E GRIDLEY RD	SY 2644
ARTESIA (1960)	62.268	L+BN NE COR OF CONC DRWY HSE NO 11256 ARTESIA BLVD 30FT#S C/L W OF GRIDLEY RD	SY 2645
BASELINE (1955)	173.417	L+BN E COR RET WALL S SIDE DRWY HSE NO 11761 COLIMA RD @ NW COR LEFFINGWELL RD + COLIMA RD 60FT# N C/L	SY 2747A
ARTESIA (1960)	58.411	L+BN E CONC CB OF DRWY HSE NO 13500 ARTESIA BLVD 55FT# S C/L	SY 2760
ARTESIA (1960)	56.186	L+T E EDGE OF E CONC DRWY STRIP TO HSE NO 13738 ARTESIA BLVD 55FT# S C/L ARTESIA BLVD + 195FT# W C/L INT ARTESIA BLVD + MARWARDT AVE	SY 2762

QUAD-YEAR	ELEV	DESCRIPTION (INCLUDE QUAD AND YEAR IN DESCRIPTION)	BM NUMBER
ARTESIA (1960)	56.199	L+T @ C/L INT ARTESIA BLVD + MARQUARDT AVE	SY 2763
ARTESIA (1960)	62.300	COE BRASS MON ON E END OF BRIDGE NO 53-277 18FT# S C/L ARTESIA BLVD + 1000FT# W VALLEY VIEW AVE MKD (CC33 1958)	SY 2764A
ARTESIA (1960)	54.185	L+T NE COR CONC LOADING PLATFORM TO DAIRY BLDG W HSE NO 13960 60FT# S C/L ARTESIA BLVD	SY 2765
ARTESIA (1960)	54.699	L+T NW COR CONC LOADING PLATFORM TO DAIRY BLDG WHSE NO 14106 75FT# S C/L ARTESIA BLVD	SY 2766
BASELINE (1955)	55.440	L+T E EDGE CONC WK TO HSE NO 14158 53FT# S C/L ARTESIA AVE 105FT# W C/L VALLEY VIEW AVE 30FT# FROM END WK	SY 2767
BASELINE (1955)	53.995	CS MON C/L INT VALLEY VIEW AVE + ARTESIA AVE OLD STYLE MON	SY 2768
BASELINE (1955)	60.431	USGS MON NW COR SPRR CONC CULV BRIDGE 26FT# E C/L VALLEY VIEW AVE 5FT# N OF RAIL 500FT# S FIRESTONE BLVD	SY 2769
BASELINE (1955)	22.488	L+BN S CB SPRING ST 1FT# E CB RET @ SE COR SPRING ST + PALO VERDE AVE	SY 2930A
BASELINE (1955)	21.800	CS MON (BR SPK IN CONC) @ INT PALO VERDE AVE + SPRING ST 18IN DN	SY 2931A
BASELINE (1955)	84.041	L+T 1FT# N BCR @ NW COR STUDEBAKER RD + ROSECRANS AVE	SY 3364A
BASELINE (1955)	83.638	L+N NR BACK WK CN SW COR ROSECRANS AVE + STUDEBAKER RD 75FT# S + 48FT# W C/L INT	SY 3365A
BASELINE (1955)	71.246	L+N IN CONC CB 13FT# W DAIRY PLATFORM 100FT# S HSE NO 16404 STUDEBAKER RD 70FT# E C/L	SY 3371
BASELINE (1955)	69.933	CS MON 5FT E C/L STUDEBAKER RD 5FT S C/L 166TH ST 10IN DEEP	SY 3372A
BASELINE (1955)	62.955	L+T DRWY HSE NO 17121 STUDEBAKER RD 50FT# W C/L 1FT# IN FROM N EDGE OF DRWY	SY 3373A
BASELINE (1955)	55.963	CS MON W/CASE + COVER @ C/L INT STUDEBAKER RD + 183RD ST	SY 3378A
BASELINE (1955)	53.542	L+T N EDGE CONC DRWY TO HSE NO 18810 50FT# E C/L STUDEBAKER RD	SY 3379
BASELINE (1955)	51.599	L+T 1FT# BACK FROM END OF CONC WK TO HSE NO 10969 SOUTH ST @ NW COR STUDEBAKER RD + SOUTH ST	SY 3380
ARTESIA (1960)	49.278	L+T CONC FOOTING SE LEG OF HI-TENSION TOWER NO 5-3 200FT# W C/L STUDEBAKER RD + 200FT# S HSE NO 19521	SY 3381
ARTESIA (1960)	44.930	RDBM TAG N CONC FOOTING TOWER NO 0-3 27FT# S C/L ENT TO EDISON STATION 155FT# E C/L STUDEBAKER RD 1000FT# N DEL AMO BLVD	SY 3382A
ARTESIA (1960)	44.651	CE TAG SW CONC FOOTING TOWER NO 0-1 50FT# S ENT TO EDISON STATION + 165FT# E C/L STUDEBAKER 1000FT# N DEL AMO BLVD	SY 3383A
ARTESIA (1960)	44.021	RDBM TAG S CB @ S END OF CUL-DE-SAC OF MAMIE AVE OPP CONC LIGHT STANDARD NO 13-71 70FT# N C/L DEL AMO BLVD	SY 3384A

QUAD-YEAR	ELEV	DESCRIPTION (INCLUDE QUAD AND YEAR IN DESCRIPTION)	BM NUMBER
ARTESIA (1960)	38.275	CS MON IN WELL W/COVER @ C/L INT DEL AMO BLVD + PIONEER BLVD	SY 3385
ARTESIA (1960)	37.822	L+T N CB 205TH ST 8FT± W CB RET @ NW COR 205TH ST + PIONEER BLVD	SY 3386
ARTESIA (1960)	38.749	L+T 4FT± FROM END S CB 206TH ST 15FT± S C/L + 65FT± W C/L PIONEER BLVD	SY 3387
ARTESIA (1960)	37.304	L+T E CB PIONEER BLVD 33FT± S C/L 208TH ST PROD	SY 3388
BASELINE (1960)	34.964	CS MON IN WELL W/COVER @ C/L INT PIONEER BLVD + CENTRALIA RD WLY	SY 3389
ARTESIA (1960)	33.865	L+T E CB PIONEER BLVD 40FT± E C/L + 50FT± N C/L PROD 215TH ST	SY 3390A
ARTESIA (1960)	34.025	RDBM TAG W CB 3FT± N BCR @ NW COR PIONEER BLVD + 215TH ST 60FT± N + 40FT± W C/L INT	SY 3391A
ARTESIA (1960)	33.581	L+T CONC WK TO HSE NO 21603 PIONEER BLVD 30FT± W OF C/L PIONEER BLVD + 65FT± S C/L 216TH ST	SY 3392A
ARTESIA (1960)	31.967	CS MON IN WELL W/COVER @ C/L INT PIONEER BLVD + CARSON ST	SY 3393
ARTESIA (1960)	29.930	L+T N CB CARSON ST 0.5FT± E OF BCR 40FT± N + 44FT± E C/L INT CARSON ST + JUAN AVE	SY 3396A
ARTESIA (1960)	31.757	L+T S CB CARSON ST 1.0FT± E OF BCR + 40FT± S + 65FT± E C/L INT NCRWALK BLVD	SY 3397A
ARTESIA (1960)	31.935	L+T SE COR CONC PORCH TO BLDG @ NW COR CARSON ST + BELSHIRE AVE	SY 3398A
ARTESIA (1960)	43.205	US ARMY CORPS OF ENGR BRASS DISK MKD (CC 13 1957) ON TOP OF WING WALL @ NW COR OF BRIDGE NO 55-147 OVER THE COCYTE CREEK 147FT± E + 40FT± N C/L OF INT	SY 3399A
ARTESIA (1960)	35.246	BOAT SPK 1.0FT± S OR N END OF CULV HDWL 66.5FT± N + 38FT± W OF BLOOMFIELD AVE	SY 3400A
ARTESIA (1960)	35.516	L+T N END WK TO HSE NO 21209 + 100FT± W C/L BLOOMFIELD AVE	SY 3401
ARTESIA (1960)	34.096	CS MON IN WELL W/COVER @ C/L INT CENTRALIA RD + BLOOMFIELD AVE	SY 3402
ARTESIA (1960)	37.383	LA CO RD DEPT BM TAG W CB BLOOMFIELD AVE + 295FT± N OF LEMMING ST 40FT± W C/L BLOOMFIELD AVE	SY 3403A
ARTESIA (1960)	39.276	CS MON IN WELL W/COVER @ C/L INT DEL AMO BLVD + BLOOMFIELD AVE	SY 3404A
ARTESIA (1960)	45.870	L+SPK NW COR CONC BASE TO SEMAPHORE SIG CONTROL BOX 30FT± E C/L BLOOMFIELD AVE + 12FT± S PERR TRACK	SY 3405A
ARTESIA (1960)	42.909	L+BN 1FT± N BCR IN CONC CB 50FT± S HSE NO 19631 + 25FT± W C/L BLOOMFIELD AVE	SY 3406A
ARTESIA (1960)	44.448	L+T WK 5FT± N PORCH STEPS TO HSE NO 19226 @ NE COR 193RD ST + BLOOMFIELD AVE	SY 3408A
ARTESIA (1960)	44.786	RD MON 6IN DN ON NW COR BLOOMFIELD AVE + SOUTH ST 86FT± W + 25FT± N C/L INT MKD (LA CO RD DEPT BM 176)	SY 3409

QUAD-YEAR	ELEV	DESCRIPTION (INCLUDE QUAD AND YEAR IN DESCRIPTION)	BM NUMBER
ARTESIA (1960)	45.814	RDBM TAG S CB 1FT± E BCR @ SE COR SOUTH ST + GRAYLAND AVE 40FTS8 S + 56FT± E C/L INT	SY 3411A
ARTESIA (1960)	48.814	L+BN NE COR CONC BASE TC WIG WAG SIGNAL CONTROL BOX 15FT± W OF PERR TRACKS + 30FT± S OF C/L SOUTH ST BOX NO 6N 18.60	SY 3413
ARTESIA (1960)	47.423	2 CS MON W/CASE + COVER USED SW MON @ C/L INT SOUTH ST + PIONEER BLVD	SY 3414
ARTESIA (1960)	47.510	L+T 4FT± S BCR @ NE COR PIONEER BLVD + SOUTH ST	SY 3415
ARTESIA (1960)	48.681	L+BN 1FT± N BCR @ NW COR PIONEER BLVD + 187TH ST	SY 3416
ARTESIA (1960)	49.401	L+T CTR CB RET @ NE COR PIONEER BLVD + 186TH ST	SY 3417
ARTESIA (1960)	54.211	L+BN N CB ASHWORTH ST 5FT± E BCR NE COR ASHWORTH ST + PIONEER BLVD	SY 3418
ARTESIA (1960)	54.868	BT SPK IN END OF CONC WK TO HSE NO 17726 @ NE COR PIONEER BLVD + 178TH ST	SY 3419
ARTESIA (1960)	55.798	L+T NW COR WK TO HSE NO 17528 PIONEER BLVD 60FT± N 176TH ST + 75FT± E PIONEER BLVD	SY 3420
BASELINE (1955)	50.152	CS MON 88FT± S C/L SOUTH ST 9FT± E C/L PALO VERDE AVE	SY 3686
BASELINE (1955)	66.415	FC BR CAP @ E END BRIDGE OVER THE SAN GABRIEL RIV ON SOUTH ST @ SE COR OF BRIDGE BM 74-54	SY 3687
BASELINE (1955)	71.010	L+T @ W END OF BRIDGE OVER SAN GABRIEL RIV ON S SOUTH ST @ SW COR BRIDGE ON S CB	SY 3688
ARTESIA (1960)	29.752	CS CONTROL SYSTEM STD DISC 46FT± N C/L CARSON ST + 46FT± W C/L NORWALK BLVD	SY 3861
BASELINE (1955)	58.159	L+BN N END WK TO CROWN FERTILIZER CO 55FT± W C/L VALLEY VIEW AVE	SY 4163
BASELINE (1955)	43.961	CS MON IN WELL 10IN DN CN SW COR DEL AMO BLVD + PALO VERDE AVE 23FT± W + 85FT± S C/L INT MKD (BM 9-1C)	SY 4993
BASELINE (1955)	45.042	L+T E CB 17FT± S BCR @ SE COR DEL AMO BLVD + PALO VERDE AVE 90FT± S + 30FT± E C/L INT MKD (BM)	SY 4994
BASELINE (1960)	43.947	RDBM TAG N CB DEL AMO BLVD 40FT± N C/L + 85FT± W C/L PROD MAMIE AVE	SY 4995
BASELINE (1955)	48.158	L+T W CB 3FT± N BCR @ NW COR PALO VERDE AVE + CANDLEWOOD ST 7CFT± N + 28FT± W C/L INT MKD (BM)	SY 5016
BASELINE (1955)	48.161	L+T S CB 3FT± W BCR @ SW COR PALO VERDE AVE + CANDLEWOOD ST 68FT± W + 38FT± S C/L INT MKD (BM)	SY 5017
BASELINE (1955)	47.050	L+BR W CB 1FT± N BCR @ NW COR PALO VERDE AVE + CARFAX AVE 75FT± N + 30FT± W C/L INT MKD (BM)	SY 5018
BASELINE (1955)	47.023	L+BR E CB 1FT± N BCR @ NE COR PALO VERDE AVE + EBERLE ST 5CFT± N + 30FT± E C/L INT MKD (BM)	SY 5019
BASELINE (1955)	39.188	CS MON IN WELL 10IN DN @ OR NR C/L INT PALO VERDE AVE + ARBCR RD USE S EDGE	SY 5020

QUAD-YEAR	ELEV	DESCRIPTION (INCLUDE QUAD AND YEAR IN DESCRIPTION)	BM NUMBER
BASELINE (1955)	41.779	L+BN N CB 73FT± W BCR @ NW COR PALO VERDE AVE + ARBOR RD 138FT± W + 18FT± N C/L INT (ALONG FC R/W) CB MKD (LC 28)	SY 5021
BASELINE (1955)	36.633	CS MON IN WELL 12IN DN @ OR NR C/L INT PALO VERDE AVE + CENTRALIA ST USE W EDGE	SY 5022
BASELINE (1955)	38.567	RD HD SPK S CB (W SIDE BRIDGE NC B950) 140FT± W BCR @ SW COR PALO VERDE AVE + CENTRALIA ST 205FT± W + 18FT± S C/L INT CB MKD (KN 240)	SY 5023
BASELINE (1955)	35.602	CS MON IN WELL 12IN DN @ OR NR C/L INT PALO VERDE AVE + HARVEY WAY	SY 5024
BASELINE (1955)	36.714	L+BN E CB 1FT± S BCR @ SE COR PALO VERDE AVE + HARVEY WAY 30FT± E + 57FT± S C/L INT	SY 5025
BASELINE (1955)	37.006	RDBM TAG W CB 6FT± N BCR @ NW COR PALO VERDE AVE + CARSON ST 82FT± N + 30FT± W C/L INT	SY 5026
BASELINE (1955)	36.978	RDBM TAG E CB 6FT± N BCR @ NE COR PALO VERDE AVE + CARSON ST 82FT± N + 30FT± E C/L INT	SY 5027
ARTESIA (1960)	34.994	RDBM TAG N CB 2FT± W BCR @ NW COR CARSON ST + KNOXVILLE AVE 82FT± N + 45FT± W C/L INT	SY 5032
ARTESIA (1960)	35.233	RDBM TAG N CB 2FT± E BCR @ NE COR CARSON ST + KNOXVILLE AVE 82FT± N + 44FT± E C/L INT	SY 5033
ARTESIA (1960)	35.326	RDBM TAG W CB 1FT± S BCR @ NW COR CARSON AVE + LOS COYOTES DIAG 85FT± N + 40FT± W C/L INT	SY 5034
ARTESIA (1960)	34.459	RD BM TAG E CB 2FT± N BCR @ NE COR CARSON ST + LOS COYOTES DIAG 100FT± N + 40FT± E C/L INT	SY 5035
ARTESIA (1960)	52.921	COE BR CAP SW COR BRIDGE OVER SAN GABRIEL RIV 4FT± S CB FACE MKD (SG 5 1958)	SY 5036
ARTESIA (1960)	51.991	COE BR CAP SE COR BRIDGE OVER SAN GABRIEL RIV 2FT± S CB FACE MKD (SG 6 1958)	SY 5037
ARTESIA (1960)	34.204	RDBM TAG CONC HDWL 50FT± S C/L CARSON ST + 1000FT± E INT CARSON ST + BRIDGE OVER SAN GABRIEL RIV	SY 5038
ARTESIA (1960)	33.559	USC+GS BR CAP IN CATCH BASIN 45FT± N C/L CARSON ST + 1000FT± E INT CARSON ST + BRIDGE OVER SAN GABRIEL RIV MKD (F780 1946)	SY 5039
ARTESIA (1960)	34.266	RDBM TAG E END CONC HDWL 46FT± S C/L CARSON ST + 2000FT± E INT CARSON ST + BRIDGE OVER SAN GABRIEL RIV	SY 5040
ARTESIA (1960)	33.250	RDBM TAG N CB NR ENT TO INLET 40FT± N C/L CARSON ST + 2000FT± E INT CARSON ST + BRIDGE OVER SAN GABRIEL RIV	SY 5041
ARTESIA (1960)	33.085	RDBM TAG E END CONC HDWL 46FT± S C/L CARSON ST + 2000FT± E INT CARSON ST + BRIDGE OVER SAN GABRIEL RIV	SY 5042
ARTESIA (1960)	41.700	CS MON IN WELL 10IN DN 16FT± N C/L SOUTH ST+ 129FT± W OF W P/L HSE NO 13014 1FT± W CARMENITA RD	SY 6083
ARTESIA (1960)	43.553	RDBM TAG E RET WALL OF DRWY @ HSE NO 13011 SOUTH ST NR W P/L PROLONGATION OF HSE NO 13014 0.5MI± W CARMENITA RD	SY 6084

**DISTURBED**



QUAD-YEAR	ELEV	DESCRIPTION (INCLUDE QUAD AND YEAR IN DESCRIPTION)	BM NUMBER
ARTESIA (1960)	40.369	CS MON FLUSH 23FT± N C/L DEL AMO BLVD 1750FT± W PIONEER BLVD 4FT± W PP 165115E MKD (BM SD 1839) 2IN IP MARKER 6IN S	SY 6086
ARTESIA (1960)	40.049	L+BN W END CATCH BASIN 35FT± W OF DRWY TO SCHOOL 40FT± N C/L DEL AMO BLVD 1300FT± W PIONEER BLVD	SY 6087
ARTESIA (1960)	40.890	RDBM TAG W CB OF SCHOOL DRWY 55FT± N C/L DEL AMO BLVD 1300FT± W PIONEER BLVD	SY 6088
ARTESIA (1960)	38.593	L+T N CB 0.1FT± E BCR @ NE COR DEL AMO BLVD + JERSEY AVE 40FT± N + 55FT± E C/L INT	SY 6089
ARTESIA (1960)	39.521	L+BR N CB 45FT± E BCR @ NE COR DEL AMO BLVD + 40FT± N + 160FT± E C/L INT	SY 6090
BASELINE (1955)	19.908	CS MON 10IN DN 74FT± S C/L SPRING ST + 114FT± W C/L STUDEBAKER RD MKD (BM 8-33 1951 RE 63)	SY 6160
BASELINE (1955)	22.311	USC+GS DISK IN TOP CONC POST 19FT± W OF FENCE AROUND PUMP STATION @ LONG BEACH WATER DEPT WISE WELL NO 1 4FT± N PP NO 444799E 2FT± E OF BOUNDARY FENCE + 16FT± S OF WITNESS POST + 110FT± S C/L SPRING ST NR STUDEBAKER RD MKD (A779 1946)	SY 6161
BASELINE (1955)	29.028	USC+BS BR DISK IN SE COR CONC BLOCK FOR MANHOLE 84FT± W OF W END BRIDGE NO B96C + 60FT± N C/L SPRING ST ON SPRING ST @ SAN GABRIEL RIV MKD (J-51 RESET 1952)	SY 6162
BASELINE (1955)	37.787	CS CONTROL SYSTEM TRAVERSE MON 14IN DN 2FT± S OF S CB + 15FT± W OF W END BRIDGE NO B96C ON SPRING ST @ SAN GABRIEL RIV MKD (ARTESIA B-11 1954)	SY 6163
BASELINE (1955)	39.512	CS CONTROL SYSTEM REFERENCE MARK IN TOP CONC ABUT 3FT± S CB @ SE COR BRIDGE NO B96C ON SPRING ST @ SAN GABRIEL RIV MKD (ARTESIA B-11 RM NO 1 1954)	SY 6165
ARTESIA (1960)	27.659	USC+GS DISK TOP CONC POST 35FT± E C/L NORWALK BLVD + 23FT± S C/L POST @ FENCE COR MKD (S-779 1946)	SY 6169

2 OUT